

EMH Wire Rope Hoists

Dimensions and Specifications

Hoist Model: EM 1000D
Trolley Type: Top Running for Double Girder Cranes

Reeving: 4 to 1

Capacities: 5 tons

Rope Diameter:	8 mm
Drum Diameter:	6.75"
Sheave Diameter:	6.25"
Hoist Motor HP:	7.2/1.2
Trolley Motor HP:	2 x 0.5
Speeds (fpm):	16/2.6, 20/3.2, 25/4.1
Std. Trolley Speed (fpm):	80 VFD

Duty Service Classification		FEM	HMI
Capacity in US Tons	5	1	H3

Dimensions (inches):		
Refer to drawing below. M, T and Standard SP (trolley gauge) dimensions plus weight shown in adjacent tables.	B:	27.5
	C:	11.25
	DA:	4
	DL:	5
	E:	2.75
	F:	2.25
	G:	3.375
	H:	18
	K:	4.5
	O *:	16.5
	P:	3.125
	R:	42.125
	U *:	---
	X:	---

Standard SP (trolley gauge):			
Varies with lifts shown at right.	20 ft.	33 ft.	50 ft.
	63	78.75	98.5

Available Lifts (feet):				
M, T, and Wt. vary with lift.		M (in.)	T (in.)	Wt. (lbs.)
	20	4.25	33.625	1276
	33	7	42	1364
	50	10.375	54.5	1496

* Dimensions O and U may vary depending on the type of control.

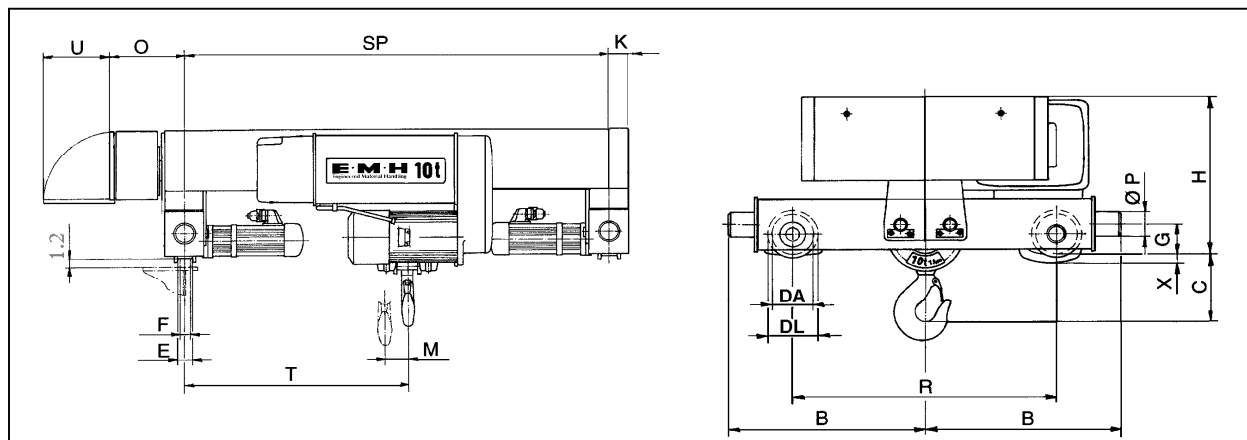

EMH
Engineered Material Handling