

# EMH Wire Rope Hoists

## Dimensions and Specifications

Hoist Model: EM 2000D  
Trolley Type: Top Running for Double Girder Cranes

Reeving: 8 to 2

Capacities: 5 and 7.5 tons

Rope Diameter:	2x6.4 mm
Drum Diameter:	7.5"
Sheave Diameter:	6.75"
Hoist Motor HP:	8/1.34
Trolley Motor HP:	2 x 0.5
Speeds (fpm):	16/2.6
Std. Trolley Speed (fpm):	80 VFD

Duty Service Classification		FEM	HMI
Capacity in US Tons	5	2	H4
	7.5	2	H4

Dimensions (inches):		
Refer to drawing below. M, T and Standard SP (trolley gauge) dimensions plus weight shown in adjacent tables.	B:	28
	C:	13
	DA:	5.125
	DL:	6.125
	E:	2.5
	F:	2.25
	G:	5
	H:	21.25
	K:	3.875
	O *:	16.5
	P:	3.125
	R:	42
	U *:	---
	X:	---

Standard SP (trolley gauge):			
Varies with lifts shown at right.	7 ft.	18 ft.	31 ft.
	63	78.75	98.5

Available Lifts (feet):				
M, T, and Wt. vary with lift.		M (in.)	T (in.)	Wt. (lbs.)
	7	0	32	1400
	18	0	37	1600
	31	0	45	1720

\* Dimensions O and U may vary depending on the type of control.

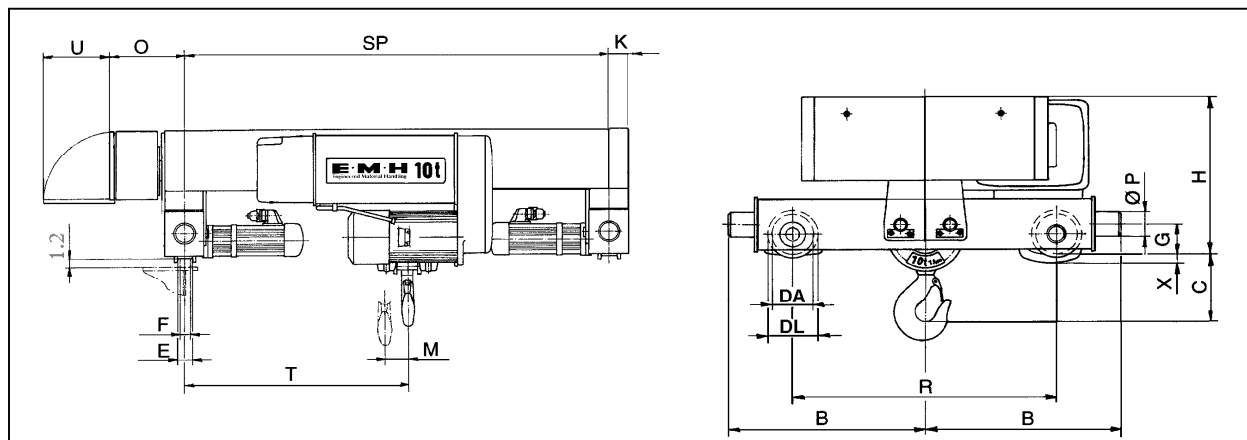

**EMH**<sup>®</sup>  
Engineered Material Handling