

EMH Wire Rope Hoists

Dimensions and Specifications

Hoist Model: EM 3000D
Trolley Type: Top Running for Double Girder Cranes

Reeving: 6 to 1

Capacities: 10 tons

Rope Diameter:	13 mm
Drum Diameter:	10.75"
Sheave Diameter:	9.125"
Hoist Motor HP:	12.4/2
Trolley Motor HP:	2 x 0.5
Speeds (fpm):	11.8/1.8, 14/2.3
Std. Trolley Speed (fpm):	80 VFD

Duty Service Classification	FEM	HMI
Capacity in US Tons	10	3
		H5

Dimensions (inches):		
Refer to drawing below. M, T and Standard SP (trolley gauge) dimensions plus weight shown in adjacent tables.	B:	33.75.
	C:	25
	DA:	8
	DL:	8.875
	E:	2.625
	F:	2.375
	G:	6.5
	H:	32
	K:	4
	O *:	17.5
	P:	3.125
	R:	48
	U *:	10.25
	X:	0.625

Standard SP (trolley gauge):			
Varies with lifts shown at right.	13 ft.	22 ft.	33 ft.
	63	63	78.75

Available Lifts (feet):				
M, T, and Wt. vary with lift.		M (in.)	T (in.)	Wt. (lbs.)
	20	4	48	2500
	33	6	49.25	2728
	50	8	51.5	2992

* Dimensions O and U may vary depending on the type of control.

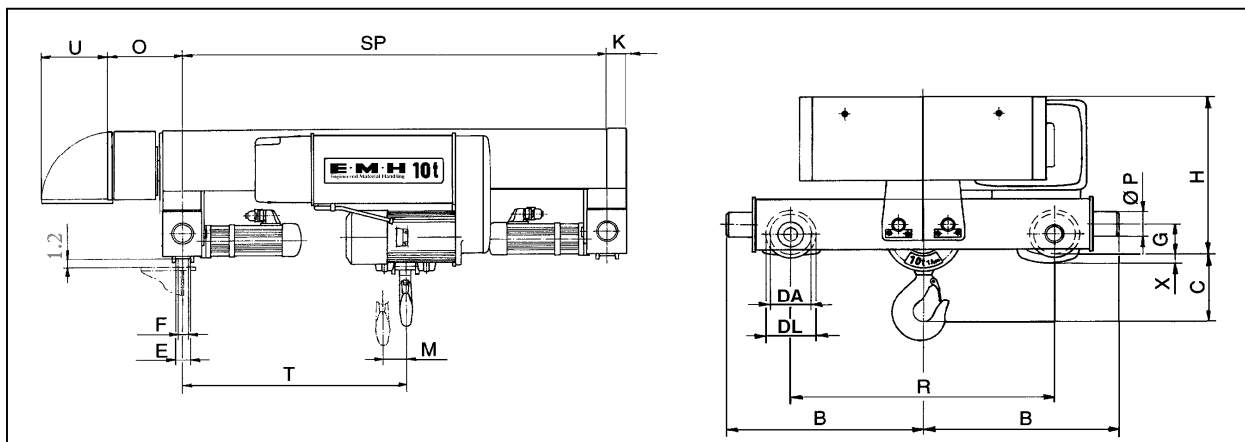

EMH[®]
Engineered Material Handling